

P Polycrystalline module
YE6220P (Solrif ®) **B** Black Series

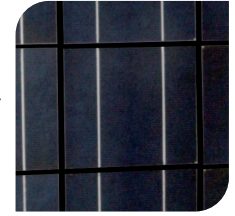

Description

Yohkon Energia, Spanish company that develops and manufactures modules and photovoltaic applications, presents its high-performance solar roof tile **YE6220P Solrif® Black**, specifically designed for roof-integrated systems thanks to the framing of the PV laminate with the patented system **SOLRIF®XL**. Each module includes 60 polycrystalline 6-inch solar cells, ensuring a maximal power production in a limited area for a longer period of time.

The module **YE6220P Solrif® Black** in addition to its own characteristics, it is packed in a transportation system, Yohkon Ecotitan®, which guarantees a safer transportation and facilitates the installation process, minimizing waste that may occur in the process of unpackaging.

Applications

- PV-grid connected
- Off-grid connected
- Roof installations

Construction

- 1) Front layer: tempered glass
- 2) First layer encapsulant
- 3) Crystalline photovoltaic cells
- 4) Second layer encapsulant
- 5) Backsheet

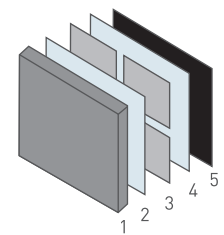

Profile

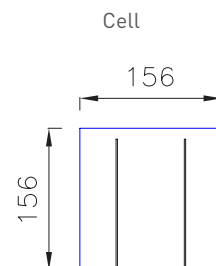
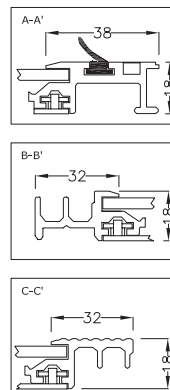

Module diagrams

Installation Dimensions

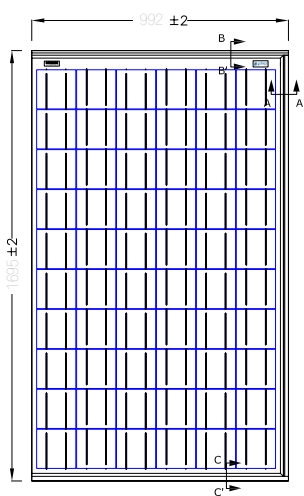

Dimensions

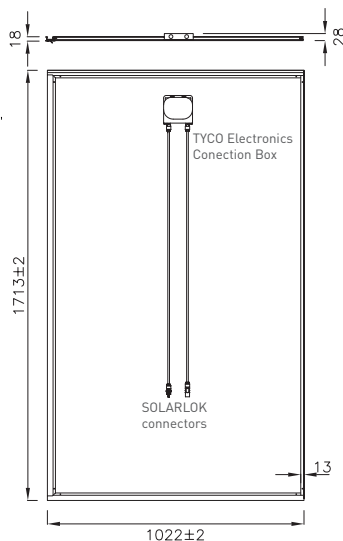

Performance parameters

Parameters		YE6220P_210	YE6220P_215	YE6220P_220
Maximum power 0%, +/-3% (Wp)	P_{mpp}	210	215	220
Voltage at maximum power point (V)	V_{mpp}	29,64	29,85	30,12
Current at maximum power point (A)	I_{mpp}	6,98	7,10	7,23
Open circuit voltage (V)	V_{oc}	35,94	36,00	36,06
Short circuit current (A)	I_{sc}	7,60	7,78	7,95
Efficiency	%	12,61	12,92	13,21

Electrical data and figures

Voltage		24 V
Normal operating cell temperature	NOCT	45°C
Temp. coeff. open circuit voltage	$Tk(V_{oc})$	-156,00(mV/°C)
Temp. coeff. short circuit current	$Tk(I_{sc})$	4,20 (mA/°C)
Max. Potency temperature coeff.	$Tk(P_n)$	-0,42 (%/°C)
Module dimensions		1713x1022 ± 2mm
Installed Module dimensions		1695x992 ± 2mm
Width with frame, including connection box		28 mm.
Weight		22 kg.
Maximum system voltage		1000 V _{DC}
Working temperature		-40°C a 85°C
Wind resistance		→130 km/h
Maximum hailstone diameter		25 mm.
Hailstone impact test speed		80 km/h

* Standard test condition: AM1.5, 1000W/m², 25°C

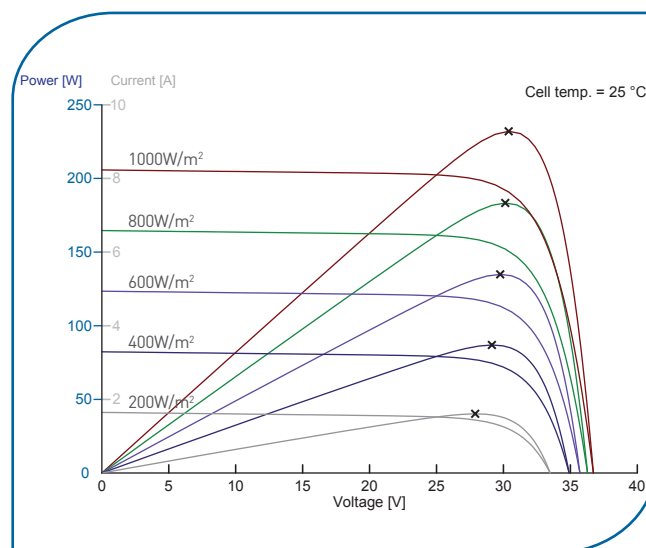

Special Features

Module classified and packed according to their power and intensity

High level of light transmittance

Anodized aluminum frame Solrif XL (18mm thick)

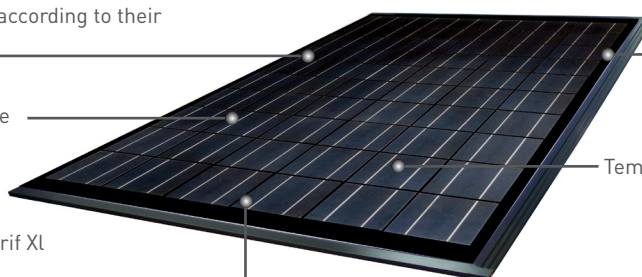

Connection Box Tyco Electronics® with 3 bypass diodes (back-side located)

Tempered glass, 4mm

Module designed and manufactured in accordance with IEC-61215, IEC-61730 standards and certified by TÜV INTERCERT.

10 years 90% production guarantee, 25 years 80% production guarantee.

5 years product guaranteed against manufacturing defects.

Packed in:



Yohkon Energía, S.A. reserves the right to modify the product without prior notification.

All panels are manufactured at within our facilities in Spain.

Before installation, please read the corresponding instructions.

*Mounting system and statics according to information from Schweizer Metallbau company (www.schweizer-metallbau.ch)

